



USER GUIDE



EPISIOTOMY MODULE

This product is available
in light and dark skin tones

61104

61124

FOR MORE SKILLS TRAINING PRODUCTS VISIT

limbsandthings.com

Sussex Street, St Philips, Bristol, BS2 0RA, UK | sales@limbsandthings.com | +44 (0) 117 311 0500

PACKAGE SUPPLIED	3
SAFETY & CLEANING INSTRUCTIONS	4
SET UP	5
• SECURING THE STAND	5
• ATTACHING EPISIOTOMY PAD	6
• FITTING BABY HEAD	7
• REUSING THE PAD	8
CARE & MAINTENANCE	11

PACKAGE SUPPLIED

Episiotomy Incision Pad (x2)

61113

61133

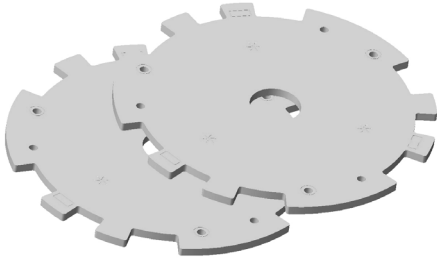

Episiotomy Repair Tape (x24)

61114

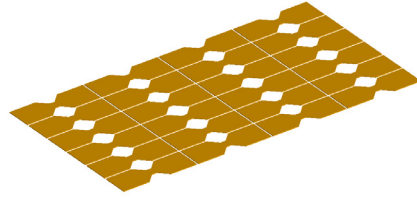

Episiotomy Baby Head

61115

61135

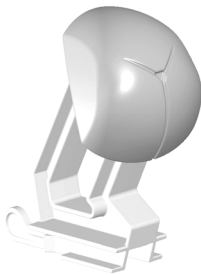

Episiotomy Illustration Pack

61116

61136



YOU'LL NEED (NOT SUPPLIED)

Perineal Repair Stand with Clamps

61109

61129

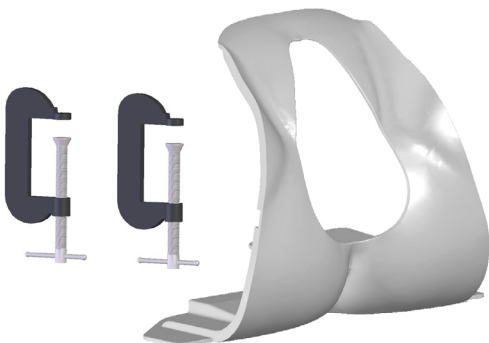

Scissors or Scalpel



Talc Powder



SAFETY & CLEANING INSTRUCTIONS

READ THE SAFETY INSTRUCTIONS CAREFULLY BEFORE USING YOUR EPISIOTOMY TRAINER

DO's



Follow all instructions. Keep these instructions. Heed all warnings.

Wear gloves at all times and remove all jewellery items. Sharp surfaces such as finger nails and rings can lead to damage of silicone parts.



Clean the product with a soft damp cloth or sponge, using only warm water with mild detergent, after every training session.

To avoid tearing, you can apply talc to the baby head and around the rim of the hole in the episiotomy pad. This will prevent friction occurring when fitting the baby head.



DON'Ts



Do not install near any heat sources, do not expose the product to flames or use near naked flame sources. Do not use flammable solvents near or on this product.

Do not use any attachments other than those supplied by the manufacturer.



Do not disassemble the product or attempt to repair a faulty unit, please return the product to Limbs & Things for assessment and repair.

Do not allow young children to use this product.



STORAGE & TRANSPORTATION



When a training session is completed, and prior to packing away, remove all parts from the Stand component so that they don't experience undue tension for long periods of time whilst in storage.



Always ensure that the product is properly packed and secured during transportation and storage in order to prevent personal injury or damage to the product.

1

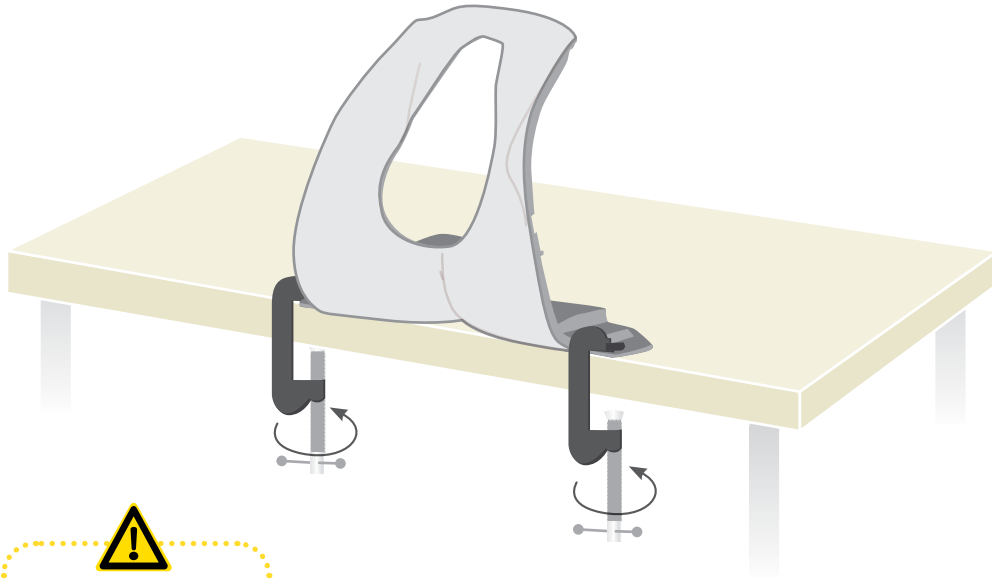

Do not over tighten

2

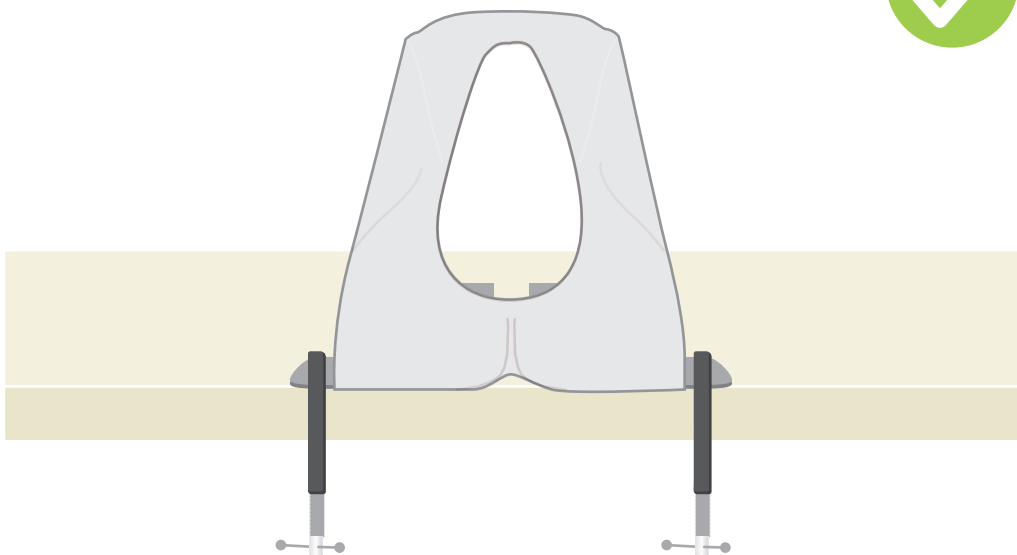

SET UP

ATTACHING EPISIOTOMY PAD

1

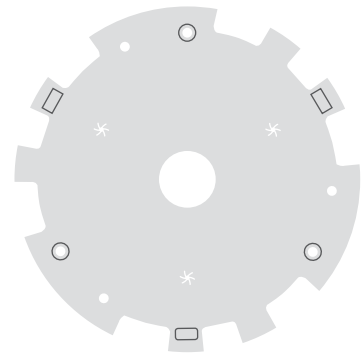
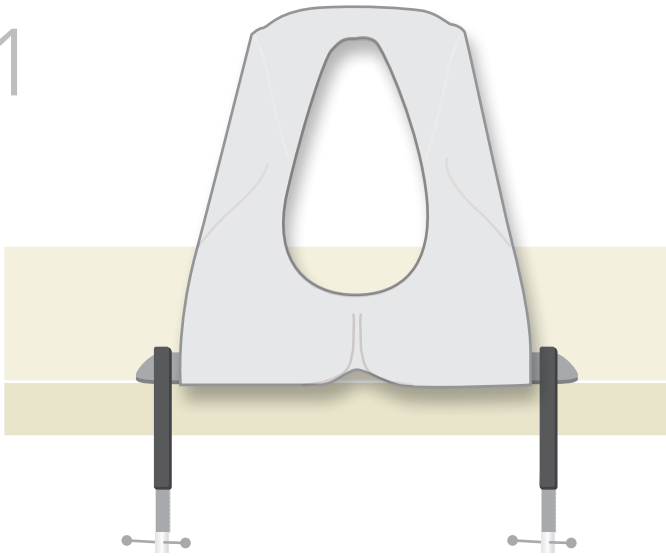

Align groove at the bottom

2

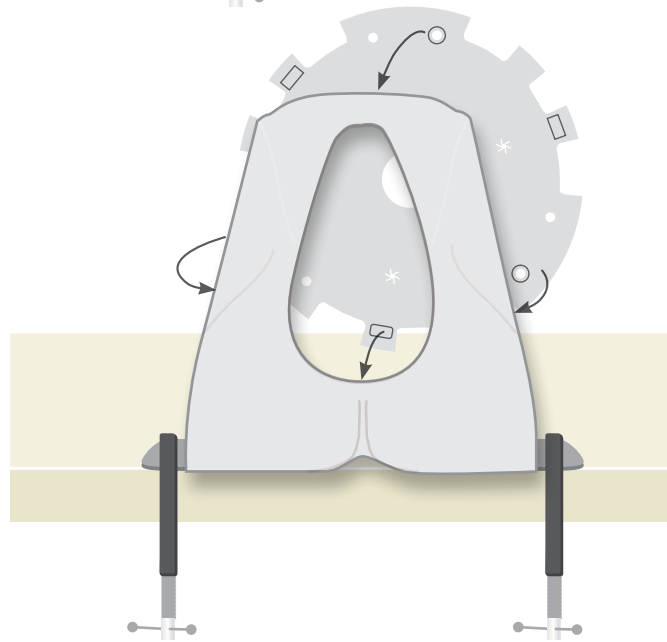

Make sure the anus is central

3

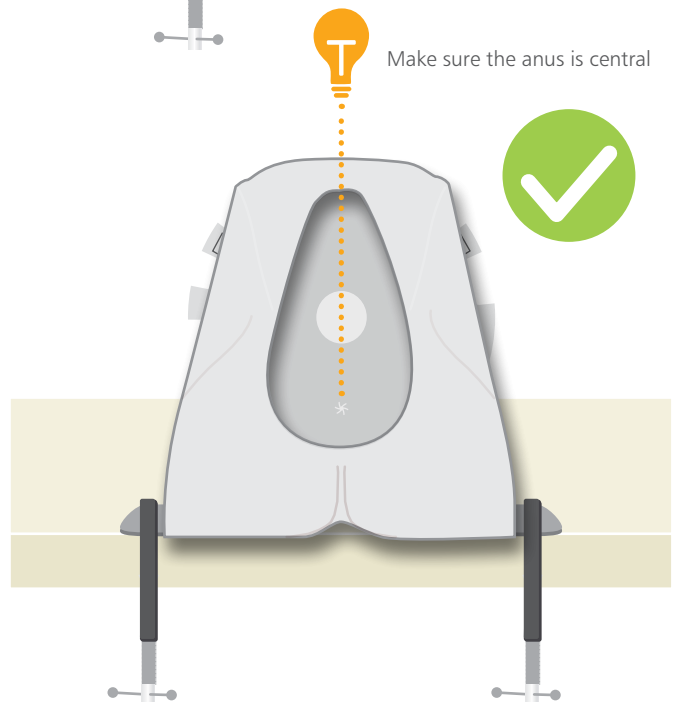
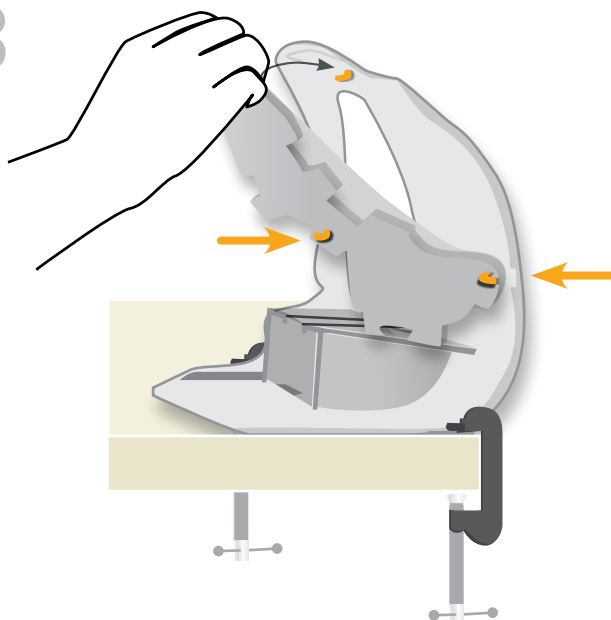

SET UP

FITTING BABY HEAD

1

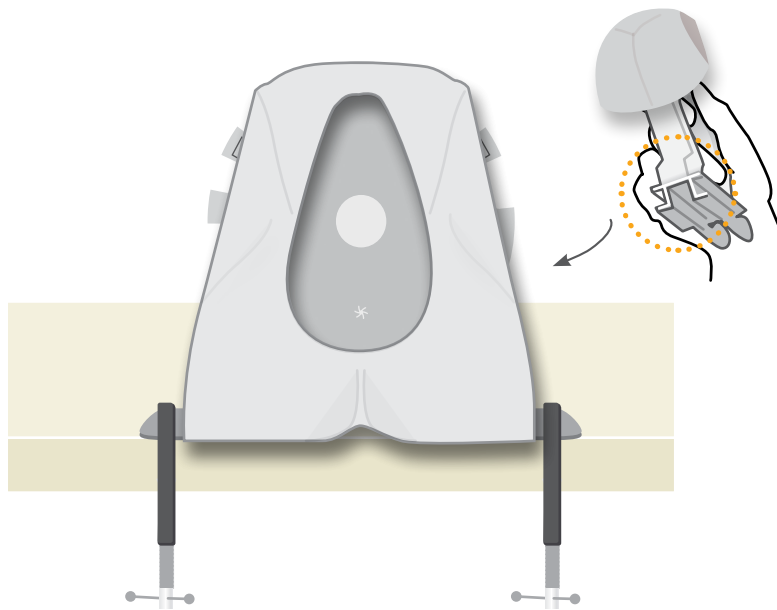



Apply talc to the baby head to prevent tearing the episiotomy pad

2

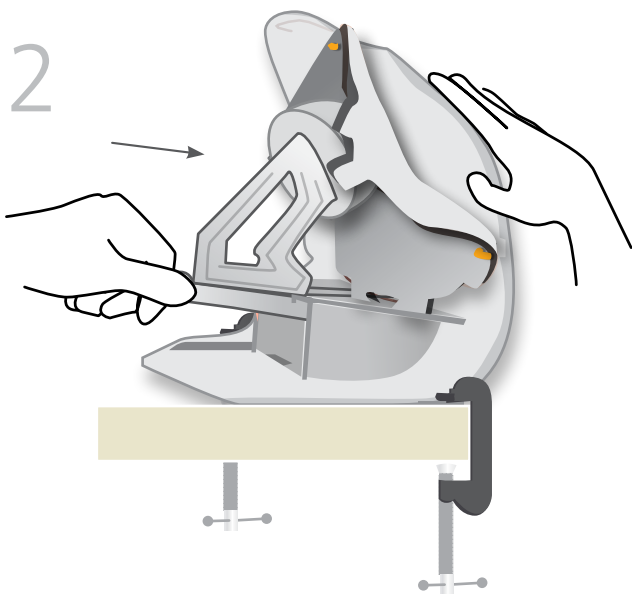

3

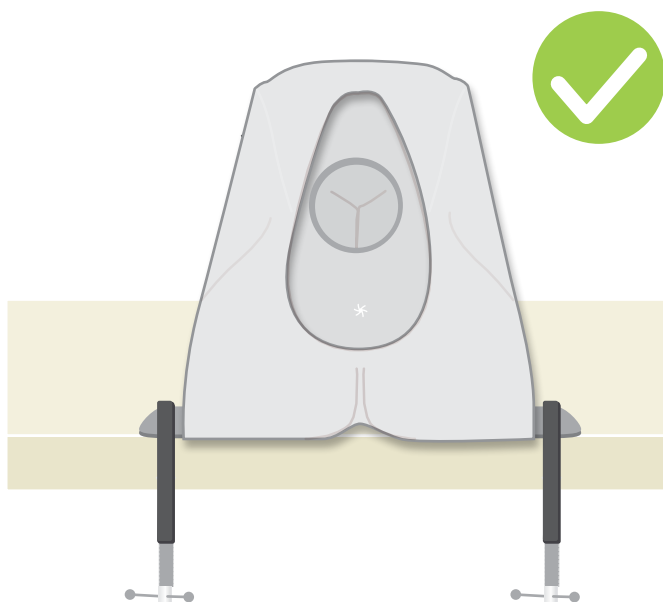

1

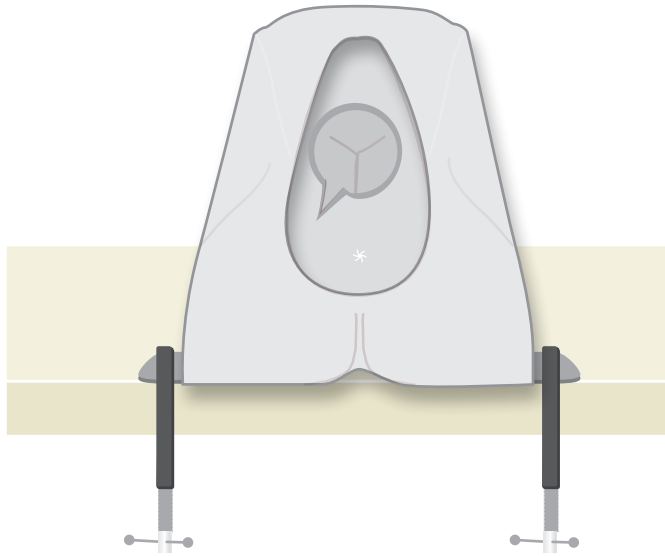

2

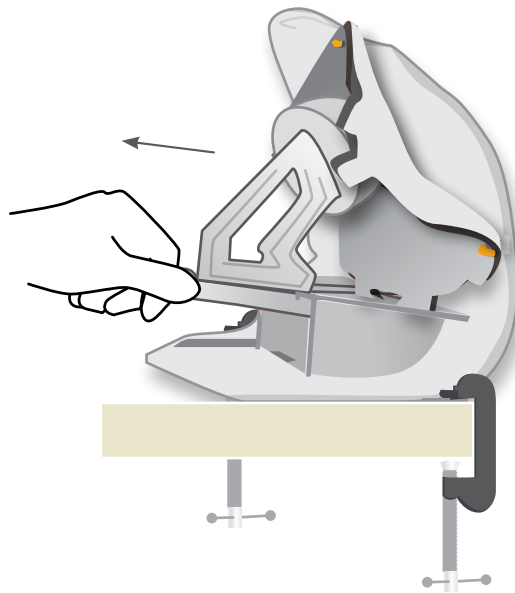

3

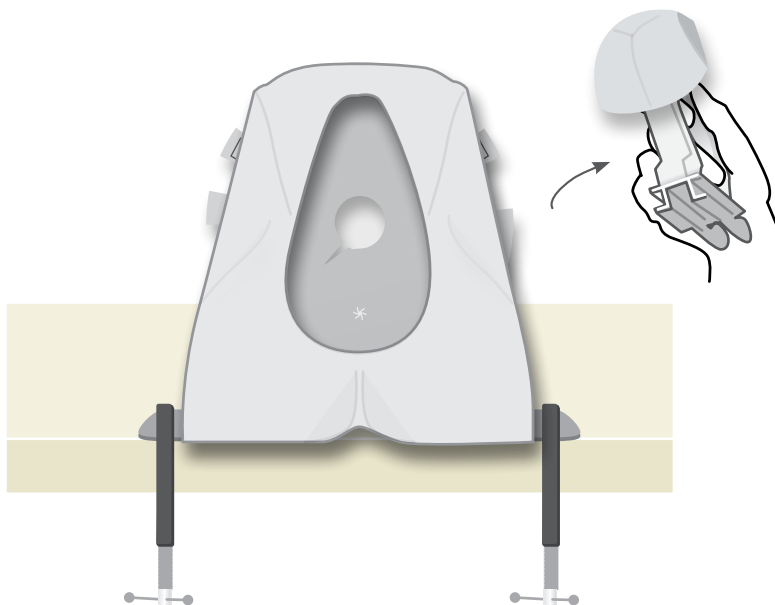

4

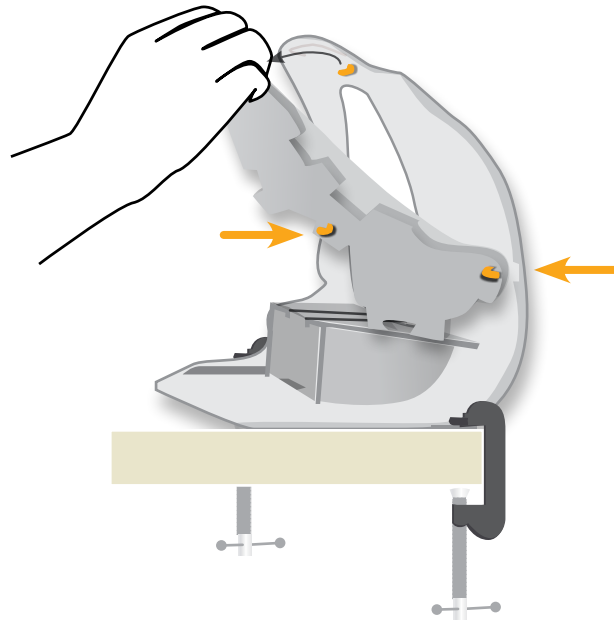

5



6

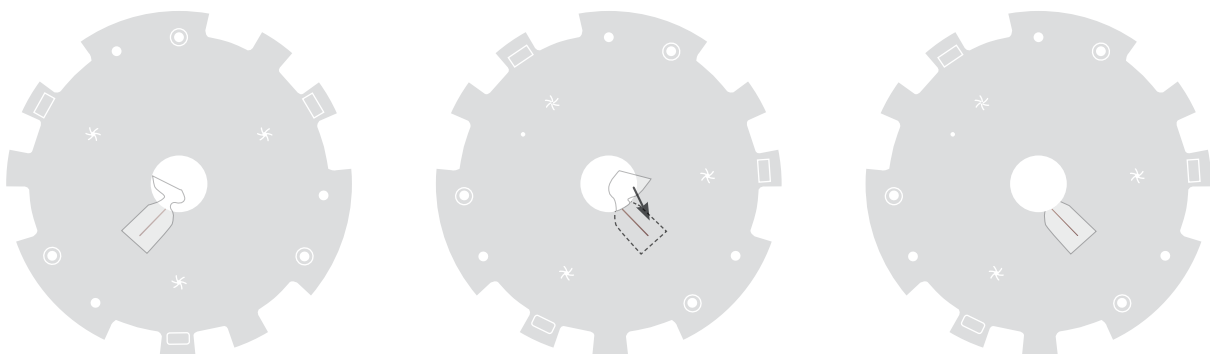

7



Rotate pad

8

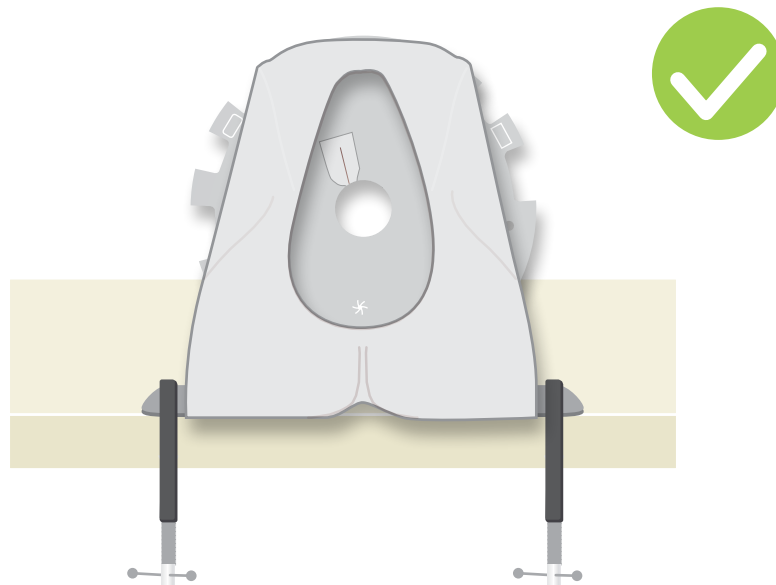

A total of 12 cuts can be made per pad

CARE & MAINTENANCE



Do not store it under tension



Clean with a damp cloth

YOU MAY
ALSO BE
INTERESTED IN...

ANAL SPHINCTER
REPAIR TRAINER

61102

61122



ANAL SPHINCTER
REPAIR BLOCK (x2)

61107

61127



TAKE A LOOK
AT OUR **VIDEO**

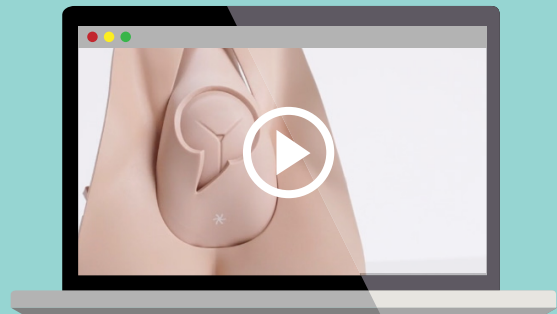

VISIT THE WEBSITE
limbsandthings.com

OR YOUTUBE CHANNEL
youtube.com/limbsandthings